

# BRONZE GATE VALVE

**PLUNGED MANDREL  
DIN 3352 T 11  
FLANGED ANDS**

<b>DN</b>	<b>15 - 100</b>
<b>PN</b>	<b>16 bar</b>
<b>T max</b>	<b>225°C</b>

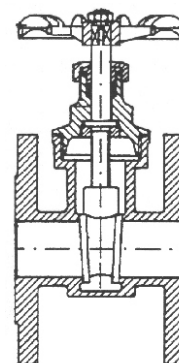

**Application:** As a closing valve in industrial pipe systems for water, steam, petroleum fluids.

**Tmax / PN:**  
 120° C max. 16 bar  
 120° C - 150° C max. 10 bar  
 150° C - 225° C max. 6 bar

<b>Materials:</b>	parts	acc to DIN	Ws. №
	Body	G - CuSn5ZnPb	2.1096.01
	Bonnet	CuZn40Pb2	2.0402
	Mandrel	CuZn40Pb2	2.0402
	Cotter	G - CuSn5ZnPb	2.1096.01
	Ring	Al	
	Sealing packing	non asbestos	

**Note:** The valve is offered with flanges acc. PN 16 ( as per table ).

**Size (mm):**

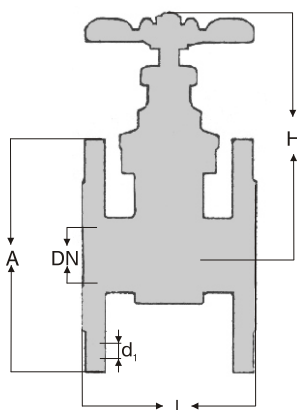

DN	L	H	A	n x d <sub>1</sub>	Kg
15	60	85	95	4 x 14	1.4
20	75	100	105	4 x 14	1.8
25	80	115	115	4 x 14	2.3
32	90	130	140	4 x 18	3.6
40	100	150	150	4 x 18	4.6
50	110	180	165	4 x 18	6.4
65	130	215	185	4 x 18	9.4
80	150	250	200	8 x 18	12.0
100	160	315	220	8 x 18	19.0