

STEEL BLIND FLANGE PN 10

ACC TO BDS 3418 - 73

DN	10 - 1000
PN	10 bar
T max	300°C



Application:

As a bond between pipe systems and armature.

Materials:

parts	acc to DIN	Ws. №
Body	Bct3cn	

Size (mm):

DN	D	D ₁	D ₂	b	f	n	d	weight kg
10	90	60	40	12	2	4	14	0.5
15	95	65	45	12	2	4	14	0.5
20	105	75	58	12	2	4	14	0.7
25	115	85	68	12	2	4	14	0.8
32	135	100	78	12	2	4	18	1.1
40	145	110	88	14	3	4	18	1.5
50	160	125	102	14	3	4	18	2.0
65	180	145	122	14	3	4	18	2.5
80	195	160	138	14	3	4	18	3.0
100	215	180	158	14	3	8	18	3.6
125	245	210	188	16	3	8	18	5.5
150	280	240	212	16	3	8	22	7.0
200	335	295	268	16	3	8	22	10.2
250	390	350	320	18	3	12	22	15.7
300	440	400	370	20	4	12	22	22.0
350	500	460	430	24	4	16	22	34.0
400	565	515	482	26	4	16	26	47.0
450	615	565	532	28	4	20	26	61.0
500	670	620	585	32	4	20	26	85.0
600	780	725	685	36	5	20	30	127.0
700	895	840	800	42	5	24	30	198.0
800	1010	950	905	48	5	24	33	290.0
900	1110	1050	1005	54	5	28	33	395.0
1000	1220	1160	1110	58	5	28	33	525.0

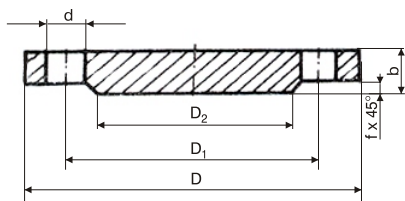

n = number of holes