

STEEL BLIND FLANGE PN 6

ACC TO BDS 3418 - 73

DN	10 - 1000
PN	6 bar
T max	300°C



Application:

As a bond between pipe systems and armature.

Materials:

parts	acc to DIN	Ws. №
Body	Bct3cn	

Size (mm):

DN	D	D ₁	D ₂	b	f	n	d	weight kg
10	75	50	35	12	2	4	12	0.3
15	80	55	40	12	2	4	12	0.4
20	90	65	50	12	2	4	12	0.5
25	100	75	60	12	2	4	12	0.6
32	120	90	70	12	2	4	14	0.9
40	130	100	80	14	3	4	14	1.2
50	140	110	90	14	3	4	14	1.4
65	160	130	110	14	3	4	14	1.9
80	185	150	128	14	3	4	18	2.7
100	205	170	148	14	3	4	18	3.3
125	235	200	178	16	3	8	18	5.1
150	260	225	202	16	3	8	18	6.2
200	315	280	258	16	3	8	18	9.2
250	370	335	312	16	3	12	18	12.8
300	435	395	365	18	4	12	22	19.4
350	485	445	415	18	4	12	22	24.0
400	535	495	465	20	4	16	22	34.0
450	590	550	520	22	4	16	22	46.0
500	640	600	570	24	4	16	22	58.0
600	755	705	670	28	5	20	26	92.0
700	860	810	775	32	5	24	26	141.0
800	975	920	880	36	5	24	30	202.0
900	1075	1020	980	40	5	24	30	273.0
1000	1175	1120	1080	44	5	28	30	315.0

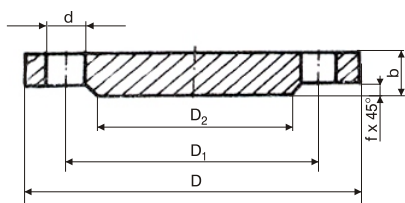

n = number of holes