

STEEL FLAT FLANGE PN 25

BDS ACC TO 3280 - 85

DN	10 - 500
PN	25 bar
T max	300°C

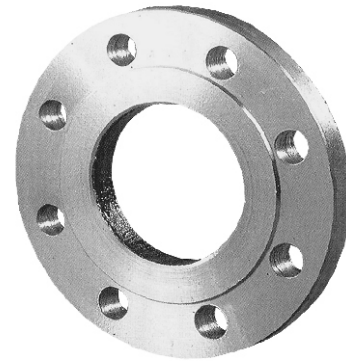

Application: As a bond between pipe systems and armature.

Materials:

parts	acc to DIN	Ws. №
Body	Bct3cn2	

Size (mm):

DN	d _{tube}	d ₀	D	D ₁	D ₂	b	f	d	number of bolts/screw	weight kg
10	14	15	90	60	42	16	2	14	4/M12	0.63
15	18	19	95	65	47	16	2	14	4/M12	0.80
20	25	26	105	75	58	16	2	14	4/M12	0.98
25	32	33	115	85	68	18	2	14	4/M12	1.18
32	38	39	140	100	78	20	2	18	4/M16	1.96
40	45	46	150	110	88	22	3	18	4/M16	2.60
50	57	59	165	125	102	24	3	18	4/M16	2.71
65	76	78	185	145	122	24	3	18	8/M16	3.22
80	89	91	200	160	133	26	3	18	8/M16	4.06
100	108	110	235	190	158	28	3	22	8/M20	6.00
125	133	135	270	220	184	30	3	26	8/M24	8.26
150	159	161	300	250	212	30	3	26	8/M24	10.40
200	219	222	360	310	278	32	3	26	12/M24	14.50
250	273	276	425	370	335	34	4	30	12/M27	18.90
300	325	328	485	430	390	36	4	30	16/M27	26.80
350	377	380	555	490	450	42	4	33	16/M30	34.55
400	426	430	620	550	505	44	4	36	16/M30	44.90
500	530	534	730	660	615	52	5	36	20/M38	67.30

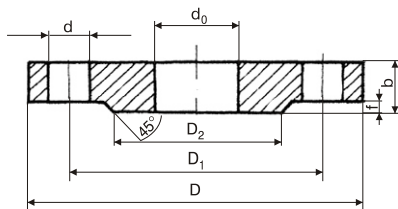

n = number of holes