

STEEL FLAT FLANGE PN 6

BDS ACC TO 3280 - 85

DN	10 - 1000
PN	6 bar
T max	300°C

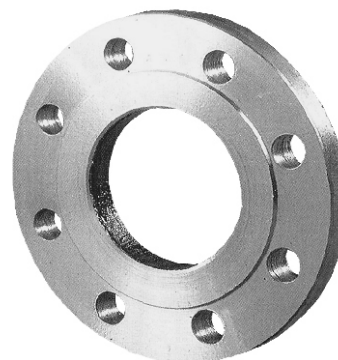

Application:

As a bond between pipe systems and armature.

Materials:

parts	acc to DIN	Ws. №
Body	Bct3cn	

Size (mm):

DN	d _{tube}	d ₀	D	D ₁	D ₂	b	f	d	number of bolts/screw	weight kg
10	14	15	75	50	35	12	2	11	4/M10	0.31
15	18	19	80	55	40	12	2	11	4/M10	0.33
20	25	26	90	65	50	14	2	11	4/M10	0.53
25	32	33	100	75	60	14	2	11	4/M10	0.64
32	38	39	120	90	70	16	2	14	4/M12	1.10
40	45	46	130	100	80	16	3	14	4/M12	1.22
50	57	59	140	110	90	16	3	14	4/M12	1.35
65	76	78	160	130	110	16	3	14	4/M12	2.89
80	89	91	190	150	128	18	3	18	4/M16	3.94
100	108	110	210	170	148	18	3	18	4/M16	4.47
125	133	135	240	200	178	20	3	18	8/M16	5.54
150	159	161	265	225	202	20	3	18	8/M16	6.07
200	219	222	320	280	258	22	3	18	8/M16	6.60
250	273	276	375	335	312	24	3	18	8/M16	8.03
300	325	328	440	395	365	24	4	22	12/M20	10.30
350	377	380	490	445	415	26	4	22	12/M20	12.60
400	426	430	540	495	465	28	4	22	16/M20	15.20
500	530	534	645	600	570	30	4	22	16/M20	20.70
600	630	636	755	705	670	30	5	26	20/M24	25.60
700	720	726	860	810	775	32	5	27	24/M24	37.10
800	820	826	975	920	880	32	5	30	24/M27	46.20
900	920	928	1075	1020	980	34	7	30	24/M27	55.10
1000	1020	1028	1175	1120	1080	36	7	30	28/M27	57.30

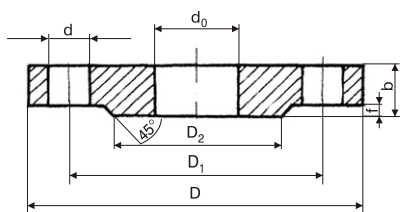

n = number of holes