

STEEL GLOBE VALVE

**FACE TO FACE ACC TO
DIN 3202 - F 1**

DN	15 - 200
PN	40 bar
T max	350°C

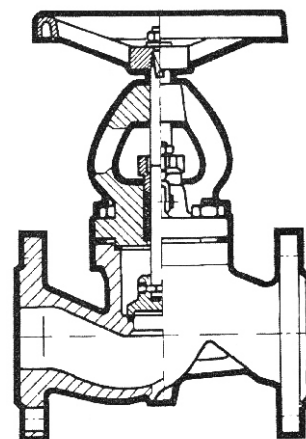
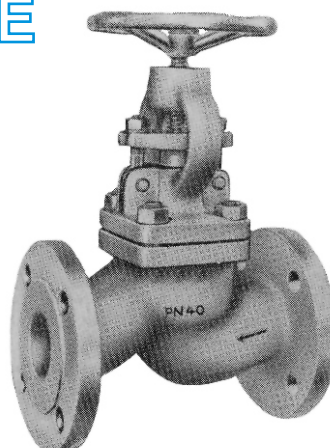

Application:

As a closing valves at industrial pipe systems for water, steam and non aggressive fluids and gases.

Materials:

parts	acc to DIN	Ws. №
Body, bonnet	GS - C 25N	1.0619.01
Ring	GG 20	0.6020
Mandrel	X20Ch13	1.4021
Globe		
Sealing rings:	X20Ch13	1.4021
- body	X20Ch13	1.4021
- globe	non asbestos	
Sealing packing		

Execution:

stop
SDNR

Size (mm):

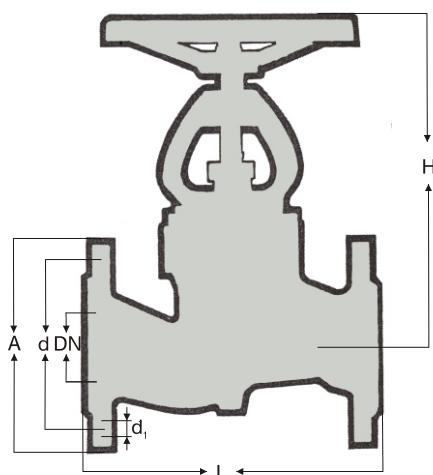

DN	L	H	A	d	n x d ₁	kg
15	130	194	95	65	4 x 14	3.6
20	150	194	105	75	4 x 14	4.5
25	160	194	115	85	4 x 14	5.5
32	180	194	140	100	4 x 18	8.0
40	200	229	150	110	4 x 18	11.0
50	230	237	165	125	4 x 18	14.0
65	290	286	185	145	8 x 18	23.0
80	310	295	200	160	8 x 18	30.0
100	350	347	235	190	8 x 22	47.0
125	400	390	270	220	8 x 26	70.0
150	480	425	300	250	8 x 26	96.0
200	600	560	375	320	12 x 30	195.0