

# STEEL GLOBE VALVE

**FACE TO FACE ACC TO  
DIN 3202 - F 1**

<b>DN</b>	<b>15 - 200</b>
<b>PN</b>	<b>16 bar</b>
<b>T max</b>	<b>200°C</b>

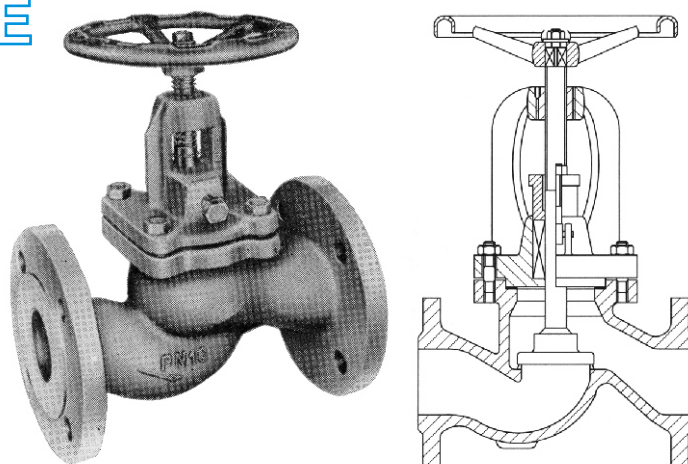

**Application:**

As a closing valves at industrial pipe systems for water, steam and non aggressive fluids and gases.

**Materials:**

parts	acc to DIN	Ws. №
Body, bonnet	GS - C 25N	1.0619.01
Ring	GG 20	0.6020
Mandrel	X20Ch13	1.4021
Globe		
Sealing rings:	X20Ch13	1.4021
- body	X20Ch13	1.4021
- globe	non asbestos	
Sealing packing		

**Execution:**

stop  
SDNR

**Size (mm):**

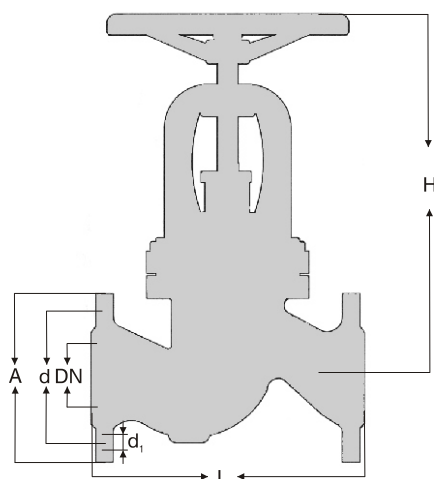

DN	L	H	A	d	n x d <sub>1</sub>	kg
15	130	194	95	65	4 x 14	3.8
20	150	194	105	75	4 x 14	4.2
25	160	194	115	85	4 x 14	5.0
32	180	194	140	100	4 x 18	7.0
40	200	229	150	110	4 x 18	9.5
50	230	237	165	125	4 x 18	11.7
65	290	286	185	145	4 x 18	20.0
80	310	295	200	160	8 x 18	24.0
100	350	347	220	180	8 x 18	38.0
125	400	390	250	210	8 x 18	54.0
150	480	425	285	240	8 x 23	85.0
200	600	560	340	295	12 x 23	164.0